

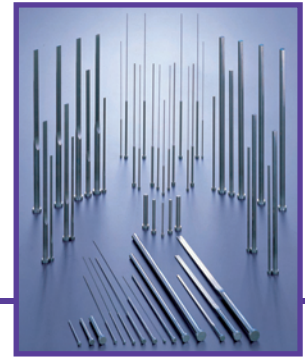

"The Pin Source"

Standards/Oversize

Ejector Pins • Core Pins • Ejector Blades
Sleeves • JIS Ejector Pins • JIS 440-C Pins



Page	Description	Page	Description
1	 STT M-2 Straight Ejector Pins Fractional Sizes	10	 SRCX (50-55 Rc) H-13 Core Pins Fractional Sizes
2	 STTO M-2 Straight Ejector Pins Oversize and .0001 increments	11	 SBE H-13 Ejector Blades Decimal Sizes
3	 STT M-2 Shoulder Ejector Pins Fractional Sizes	12	 SSL H-13 Nitride OD/ID Sleeves Fractional Sizes
4	 STTO M-2 Shoulder Ejector Pins Oversize and .0001 increments	13	 SEPH JIS M-2 Straight Ejector Pins + .0 MM Sizes - .005
5	 SRX H-13 Nitride Straight Ejector Pins Fractional Sizes	14	 SEPS JIS M-2 Straight Ejector Pins - .01 MM Sizes - .02
6	 SRX H-13 Nitride Shoulder Ejector Pins Fractional Sizes	15	 JIS M-2 Straight Ejector Pins Pricing SEPH/SEPS
7	 SRHX (50-55 Rc Core) Straight Ejectors Fractional Sizes	16	 SESH JIS M-2 Shoulder Ejector Pins + .0 MM Sizes - .005
8	 SRHX (50-55 Rc Core) Shoulder Ejectors Fractional Sizes	17	 SESS JIS M-2 Shoulder Ejector Pins - .01 MM Sizes - .02
9	 SME H-13 (Euro) Nitride Ejector Pins MM Sizes	18	 JIS M-2 Shoulder Ejector Pins Pricing SESH/SESS
10	 SRC (30-35 Rc) H-13 Core Pins Fractional Sizes	19	 S440-C JIS Straight Ejector Pins MM Sizes



M-2 Straight Ejector Pins

.0003" TOLERANCE
STANDARD INCH FRACTIONAL DIAMETERS

STT Hardened-Through HSS (60-63 Rc)

**MATERIAL: M-2 HIGH SPEED STEEL
HARDENED THROUGH 60-63 Rc**

Heads drawn for maximum toughness and easy machining



OVERSIZE STOCK!
+.0005 +.001 +.002 +.005
SEE PAGE 2

TOLERANCES			
D	H	T	L
-.0005"/-.0008" (See actual dia. below)	+.000" -.010"	+.000" -.002"	+.375" -.000"

<i>How to order: Specify</i>		
Qty.	Cat. No.	Length
12	STT-9	L-6
6	STT-13	L-8

D		H	T	SMITH CAT. NO.	NET PRICE EACH (US\$)		
NOMINAL PIN DIA.	ACTUAL PIN DIA.	HEAD DIA.	HEAD THICK.		L-6"	L-8"	L-10"
1/32"	.0308" .0305"	1/4"	1/8"	STT-2	8.64	-	-
3/64"	.0464" .0461"			STT-3	5.48	-	-
1/16"	.0620" .0617"			STT-5	4.73	8.76	-
5/64"	.0776" .0773"			STT-6	4.73	8.76	-
3/32"	.0933" .0930"			STT-7	4.38	6.92	-
7/64"	.1089" .1086"			STT-8	4.38	6.92	-
1/8"	.1245" .1242"			STT-9	2.97	4.66	-
9/64"	.1401" .1398"			STT-10	3.07	4.94	-
5/32"	.1558" .1555"	9/32"	5/32"	STT-11	3.07	5.76	-
11/64"	.1714" .1711"	11/32"	3/16"	STT-12	4.03	5.76	-
3/16"	.1870" .1867"	3/8"		STT-13	4.03	5.76	8.07
13/64"	.2026" .2023"			STT-14	4.03	5.76	8.01
7/32"	.2183" .2180"	13/32"		STT-15	4.03	5.76	8.25
15/64"	.2339" .2336"			STT-16	4.03	5.76	8.25
1/4"	.2495" .2492"	7/16"		STT-17	4.03	5.76	9.18
9/32"	.2807" .2804"	7/16"	1/4"	STT-19	6.88	10.20	13.74
5/16"	.3120" .3117"	1/2"		STT-21	6.50	9.60	12.99
11/32"	.3433" .3430"	9/16"		STT-23	8.00	11.40	15.99
3/8"	.3745"	5/8"		STT-25	8.75	13.11	17.49
	.3742"						



M-2 Straight Ejector Pins

.0003" DIAMETER TOLERANCE

OVERSIZED AND FOUR-PLACE DECIMAL DIAMETERS

STTO/STTD Hardened-Through HSS (60-63 Rc)

+ .0005 + .001 + .002 + .005

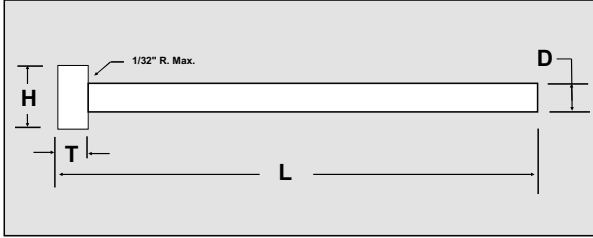

TOLERANCES				
D		H	T	L
STOCK OVERSIZED DIAMETERS	NON-STANDARD OVERSIZED .0001" DIAMETERS	+ .000" - .010"	+ .000" - .002"	+ .375" - .000"
	- .0005" - .0008" (See actual dia. below)			

D	H	T	STOCK STANDARD OVERSIZED DIAMETERS						MADE-TO-ORDER NON-STANDARD .0001" INCREMENT OVERSIZED DIAMETERS								
			SMITH CAT. NO.	ACTUAL PIN DIAMETER				NET PRICE EACH			SMITH CAT. NO.	D +.0000" - .0003"	NET PRICE EACH				
NOMINAL PIN DIA.	HEAD DIA.	HEAD THICK		+ .0005"	+ .001"	+ .002"	+ .005"	L-6"	L-8"	L-10"		DIA. RANGE	L-6"	L-8"	L-10"		
1/32"	1/4"	1/8"	STTO-2	.0313" .0310"	.0318" .0315"	.0328" .0325"	.0358" .0355"	\$ 16.50	-	-	STTD-2	.0309" - .0463"	\$ 16.50	-	-		
3/64"			STTO-3	.0469" .0466"	.0474" .0471"	.0484" .0481"	.0514" .0511"	\$ 15.90	\$ 31.00	-	STTD-3	.0465" - .0619"	\$ 15.90	\$ 31.00	-		
1/16"			STTO-5	.0625" .0622"	.0630" .0627"	.0640" .0637"	.0670" .0667"	\$ 15.90	\$ 31.00	-	STTD-5	.0621" - .0775"	\$ 15.90	\$ 31.00	-		
5/64"			STTO-6	.0781" .0778"	.0786" .0783"	.0796" .0793"	.0826" .0823"	\$ 15.50	\$ 29.30	-	STTD-6	.0777" - .0932"	\$ 15.50	\$ 29.30	-		
3/32"			STTO-7	.0938" .0935"	.0943" .0940"	.0953" .0950"	.0983" .0980"	\$ 15.50	\$ 29.30	-	STTD-7	.0934" - .1088"	\$ 15.50	\$ 29.30	-		
7/64"			STTO-8	.1094" .1091"	.1099" .1096"	.1109" .1106"	.1139" .1136"	\$ 13.95	\$ 27.10	-	STTD-8	.1090" - .1244"	\$ 13.95	\$ 27.10	-		
1/8"			STTO-9	.1250" .1247"	.1255" .1252"	.1265" .1262"	.1295" .1292"	\$ 13.95	\$ 27.15	-	STTD-9	.1246" - .1400"	\$ 13.95	\$ 27.15	-		
9/64"			STTO-10	.1406" .1403"	.1411" .1408"	.1421" .1418"	.1451" .1448"	\$ 13.95	\$ 27.15	-	STTD-10	.1402" - .1557"	\$ 13.95	\$ 27.15	-		
5/32"			9/32"	5/32"	STTO-11	.1563" .1560"	.1568" .1565"	.1578" .1575"	.1608" .1605"	\$ 15.25	\$ 28.25	-	STTD-11	.1559" - .1713"	\$ 15.25	\$ 28.25	-
11/64"			11/32"	3/16"	STTO-12	.1719" .1716"	.1724" .1721"	.1734" .1731"	.1764" .1761"	\$ 15.25	\$ 28.25	-	STTD-12	.1715" - .1869"	\$ 15.25	\$ 28.25	-
3/16"	3/8"	STTO-13	.1875" .1872"		.1880" .1877"	.1890" .1887"	.1920" .1917"	\$ 15.25	\$ 28.25	\$ 36.00	STTD-13	.1871" - .2025"	\$ 15.25	\$ 28.25	\$ 36.00		
13/64"	13/32"	STTO-14	.2031" .2028"		.2036" .2033"	.2046" .2043"	.2076" .2073"	\$ 15.25	\$ 28.25	\$ 36.00	STTD-14	.2027" - .2182"	\$ 15.25	\$ 28.25	\$ 36.00		
7/32"		STTO-15	.2188" .2185"		.2193" .2190"	.2203" .2200"	.2233" .2230"	\$ 15.25	\$ 28.25	\$ 36.00	STTD-15	.2184" - .2338"	\$ 15.25	\$ 28.25	\$ 36.00		
15/64"	7/16"	STTO-16	.2344" .2341"		.2349" .2346"	.2359" .2356"	.2389" .2386"	\$ 15.25	\$ 28.25	\$ 36.00	STTD-16	.2340" - .2494"	\$ 15.25	\$ 28.25	\$ 36.00		
1/4"		STTO-17	.2500" .2497"		.2505" .2502"	.2515" .2512"	.2545" .2542"	\$ 15.25	\$ 28.25	\$ 37.00	STTD-17	.2496" - .2544"	\$ 15.25	\$ 28.25	\$ 37.00		
9/32"	7/16"	1/4"	STTO-19		.2812" .2809"	.2817" .2814"	.2827" .2824"	.2857" .2854"	\$ 18.00	-	\$ 38.00	STTD-19	.2808" - .2856"	\$ 18.00	-	\$ 38.00	
5/16"	1/2"		STTO-21		.3125" .3122"	.3130" .3127"	.3140" .3137"	.3170" .3167"	\$ 18.00	-	\$ 38.00	STTD-21	.3121" - .3169"	\$ 18.00	-	\$ 38.00	
11/32"	9/16"		STTO-23	.3438" .3435"	.3443" .3440"	.3453" .3450"	.3483" .3480"	\$ 19.00	-	\$ 39.00	STTD-23	.3434" - .3482"	\$ 19.00	-	\$ 39.00		
3/8"	5/8"		STTO-25	.3750" .3747"	.3755" .3752"	.3765" .3762"	.3795" .3792"	\$ 19.00	-	\$ 39.00	STTD-25	.3746" - .3794"	\$ 19.00	-	\$ 39.00		

How to order:			Cat. No. +.0005", or +.001, or +.002", or +.005						Cat. No. D=.xxxx Length								
Examples			STTO-9 +.0005 L-8						STTD-11 D=.1575 L-6								
Quantity Discounts <i>Larger quantities per quotation</i>			STOCK OVERSIZED DIAMETERS						NON-STANDARD .0001" INCREMENT DIAMETERS								
			100 +	50 - 99	25 - 49	10 - 24	5 - 9	1 - 4 pcs.				100 +	50 - 99	25 - 49	10 - 24	5 - 9	1 - 4
	6" Length	Per quote		-\$9.00	-\$7.50	-\$5.00	-\$3.00	Net					-\$9.00	-\$7.50	-\$5.00	-\$3.00	Net
	8" Length			-\$19.00	-\$17.50	-\$15.00	-\$10.00						-\$19.00	-\$17.50	-\$15.00	-\$10.00	
	10" Length			-\$19.00	-\$17.50	-\$15.00	-\$10.00						-\$19.00	-\$17.50	-\$15.00	-\$10.00	



M-2 Shoulder Ejector Pins

.0003" DIAMETER TOLERANCE
STANDARD FRACTIONAL DIAMETERS

STT Hardened-Through HSS (60-63 Rc)

MATERIAL: M-2 HIGH SPEED STEEL, 60-63 Rc
HARDENED THROUGH 60-63 Rc

Heads drawn for maximum toughness and easy machining

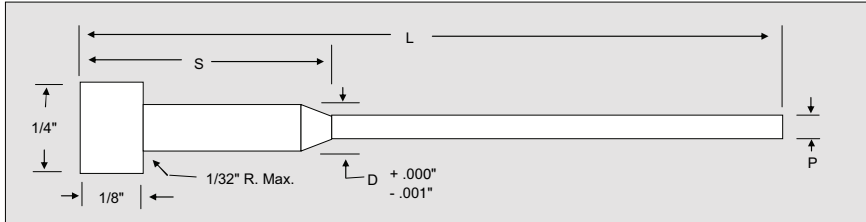

OVERSIZE STOCK!
+.0005 +.001 +.002 +.005
SEE PAGE 4

TOLERANCES			
P	H	T	L
-.0005" -.0008" (See actual diameter below)	+.000" -.010"	+.000" -.002"	+.375" -.000"

HOW TO ORDER: <i>Specify</i>		
Quantity	Cat. No.	Length
12	STT-5-2	L-6"
6	STT-8-1/2	L-8"

P		S	SMITH CATALOG NO.	NET PRICE EACH (US\$)	
NOMINAL PIN DIA.	ACTUAL PIN DIA.	SHOULDER LENGTH		L-6"	L-8"
1/32"	.0308" .0305"	1/2"	STT-2-1/2	8.64	-
		2"	STT-2-2	7.95	8.53
		3"	STT-2-3	-	8.53
		4"	STT-2-4	-	7.26
3/64"	.0464" .0461"	1/2"	STT-3-1/2	5.48	-
		2"	STT-3-2	5.36	6.92
		3"	STT-3-3	-	6.92
		4"	STT-3-4	-	6.22
1/16"	.0620" .0617"	1/2"	STT-5-1/2	4.72	8.76
		2"	STT-5-2	4.55	6.22
		3"	STT-5-3	-	6.22
		4"	STT-5-4	-	5.64
5/64"	.0776" .0773"	1/2"	STT-6-1/2	4.72	8.76
		2"	STT-6-2	4.55	6.22
		3"	STT-6-3	-	6.22
		4"	STT-6-4	-	5.64
3/32"	.0933" .0930"	1/2"	STT-7-1/2	4.38	6.92
		2"	STT-7-2	4.20	5.41
		3"	STT-7-3	-	5.41
		4"	STT-7-4	-	5.18
7/64"	.1089" .1086"	1/2"	STT-8-1/2	4.38	6.92
		2"	STT-8-2	4.20	5.41
		3"	STT-8-3	-	5.41
		4"	STT-8-4	-	5.18



M-2 Shoulder Ejector Pins

.0003" DIAMETER TOLERANCE

OVERSIZED AND FOUR-PLACE DECIMAL DIAMETERS

STTO/STTD Hardened-Through HSS (60-63 Rc)

+ .0005 + .001 + .002 + .005

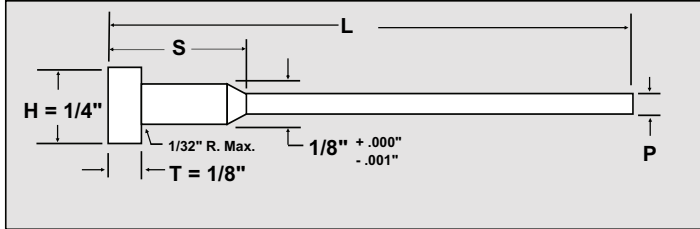

SMITH PINS M-2 High Speed Steel

Hardened-Through Ejector Pins are now available from stock in the oversized diameters of **+ .0005"**, **+ .001"**, **+ .002"**, and **+ .005"**. Diameters are held to within **.0003"** total tolerance (**-.0005"**/**-.0008"** from the corresponding nominal oversized diameter). Non-Standard diameters in **.0001"** increments from **.0309"** shown in price table below are made to order. Call for delivery.

Diameters in **.0001"** increments under **.0309"** can also be made to order. Price and delivery upon request.

TOLERANCES				
P		H	T	L
STOCK OVERSIZED DIAMETERS	NON-STANDARD OVERSIZED .0001" DIAMETERS			
- .0005" - .0008" (See actual dia. below)	+ .0000" - .0003"	+ .000" - .010"	+ .000" - .002"	+ .375" - .000"

P	S	STOCK STANDARD OVERSIZED DIAMETERS						MADE-TO-ORDER NON-STANDARD .0001" INCREMENT DIAMETERS						
		SMITH CAT. NO.	ACTUAL PIN DIAMETER				NET PRICE EACH (US\$)		SMITH CAT. NO.	D + .0000" - .0003" DIA. RANGE	NET PRICE EACH (US\$)			
			+ .0005"	+ .001"	+ .002"	+ .005"	L-6"	L-8"			L-6"	L-8"		
1/32"	1/2"	STTO-2					\$ 16.00	-	STTD-2	.0309" - .0463"	\$ 16.25	-		
	2"		.0313"	.0318"	.0328"	.0358"	\$ 15.90	\$ 18.75			\$ 16.15	\$ 18.75		
	3"		.0310"	.0315"	.0325"	.0355"	-	\$ 18.75			-	\$ 18.75		
	4"						-	\$ 18.15			-	\$ 18.15		
3/64"	1/2"	STTO-3					\$ 15.35	\$ 30.45	STTD-3	.0465" - .0619"	\$ 15.60	\$ 30.45		
	2"		.0469"	.0474"	.0484"	.0514"	\$ 15.20	\$ 18.15			\$ 15.45	\$ 18.15		
	3"		.0466"	.0471"	.0481"	.0511"	-	\$ 18.15			-	\$ 18.15		
	4"						-	\$ 17.65			-	\$ 17.65		
1/16"	1/2"	STTO-5					\$ 15.35	\$ 30.45	STTD-5	.0621" - .0775"	\$ 15.60	\$ 30.45		
	2"		.0625"	.0630"	.0640"	.0670"	\$ 15.20	\$ 18.15			\$ 15.45	\$ 18.15		
	3"		.0622"	.0627"	.0637"	.0667"	-	\$ 18.15			-	\$ 18.15		
	4"						-	\$ 17.65			-	\$ 17.65		
5/64"	1/2"	STTO-6					\$ 15.05	\$ 28.75	STTD-6	.0777" - .0932"	\$ 15.30	\$ 28.75		
	2"		.0781"	.0786"	.0796"	.0826"	\$ 14.90	\$ 17.45			\$ 15.15	\$ 17.45		
	3"		.0778"	.0783"	.0793"	.0823"	-	\$ 17.45			-	\$ 17.45		
	4"						-	\$ 17.25			-	\$ 17.25		
3/32"	1/2"	STTO-7					\$ 15.05	\$ 28.75	STTD-7	.0934" - .1088"	\$ 15.30	\$ 28.75		
	2"		.0938"	.0943"	.0953"	.0983"	\$ 14.90	\$ 17.45			\$ 15.15	\$ 17.45		
	3"		.0935"	.0940"	.0950"	.0980"	-	\$ 17.45			-	\$ 17.45		
	4"						-	\$ 17.25			-	\$ 17.25		
7/64"	1/2"	STTO-8					\$ 13.50	\$ 26.65	STTD-8	.1090" - .1244"	\$ 13.75	\$ 26.65		
	2"		.1094"	.1099"	.1109"	.1139"	\$ 13.35	\$ 16.50			\$ 13.60	\$ 16.50		
	3"		.1091"	.1096"	.1106"	.1136"	-	\$ 16.50			-	\$ 16.50		
	4"						-	\$ 16.30			-	\$ 16.30		
How to order:		Cat. No.-Shoulder + .0005 or + .001 or .002 or + .005 Length						Cat. No.- Shoulder D= .xxxx Length						
Examples		STTO-5-3 + .0005 L-8						STTD-2-1/2 P= .0400 L-6						
Quantity Discounts (LARGER QUANTITIES PER QUOTATION)			STOCK STANDARD OVERSIZED DIAMETERS						NON-STANDARD .0001" INCREMENT DIAMETERS					
			100 +	50 - 99	25 - 49	10 - 24	5 - 9	1 - 4 pcs.	100 +	50 - 99	25 - 49	10 - 24	5 - 9	1 - 4 pcs.
			Per Quote	-\$9.00	-\$7.50	-\$5.00	-\$3.00	Net	Per Quote	-\$9.00	-\$7.50	-\$5.00	-\$3.00	Net



H-13 Straight Ejector Pins

STANDARD INCH .0003" DIAMETER TOLERANCE

STANDARD FRACTIONAL +.005" AND LETTER SIZE DIAMETERS

SRX Nitrided (CORE 41-45 Rc)

MATERIAL: H-13 HOTWORK DIE STEEL
CORE: HARDENED THROUGHOUT TO 41-45 Rc
SURFACE: ION NITRIDED TO 65-74 Rc

TOLERANCES				
D		H	T	L
UP TO 1/2" DIA. & 14" LONG	-.0005" -.0008"	+.000" -.010"	+.000" -.002"	+.375" -.000"
OVER 1/2" DIA. & 14" LONG	-.0003" -.0008"			

HOW TO ORDER			
Specify:	Quantity	Cat. No.	Length
	60	SRX-17	L-6"
	12	SRX-25	L-10"

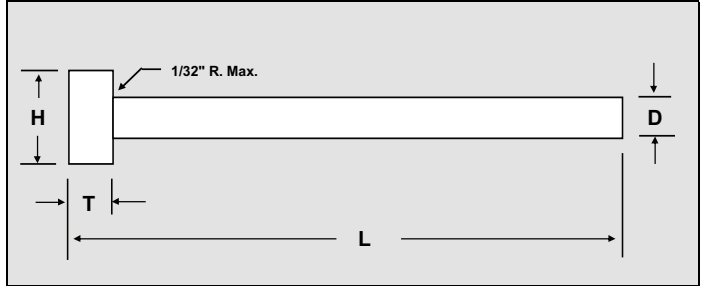

D		H	T	SMITH CATALOG NUMBER	L-4"	L-6"	L-10"		L-14"		L-18"		L-25"	L-36"	Pkg. Qty.		
NOMINAL SIZE	DECIMAL EQUIV.	HEAD DIA.	HEAD THICK.		STD. DIA.	STD. DIA.	STD. DIA.	+.005" DIA.	STD. DIA.	+.005" DIA.	STD. DIA.	+.005" DIA.	STD. DIA.	STD. DIA.			
1/32"	.0313"	1/4"	1/8"	SRX-2	-	-	-	-	-	-	-	-	-	-	12		
3/64"	.0469"			SRX-3	4.24	4.30	-	-	-	-	-	-	-	-		-	
1/16"	.0625"			SRX-5	3.95	4.00	5.17	6.02	-	-	-	-	-	-		-	
5/64"	.0781"			SRX-6	3.95	4.00	4.83	6.02	-	-	-	-	-	-		-	
3/32"	.0938"			SRX-7	3.56	3.61	4.06	5.28	-	-	-	-	-	-		-	
7/64"	.1094"			SRX-8	3.56	3.61	4.06	5.28	-	-	-	-	-	-		-	
1/8"	.1250"			SRX-9	1.90	1.96	2.20	2.48	2.75	2.95	6.38	-	-	-		-	
9/64"	.1406"			SRX-10	-	2.30	2.35	2.67	3.20	-	6.07	-	-	-		-	
5/32"	.1563"			9/32"	5/32"	SRX-11	1.99	2.05	2.30	2.59	2.96	3.26	4.13	-		-	-
11/64"	.1719"			11/32"	3/16"	SRX-12	2.39	2.45	2.50	2.84	3.32	-	-	-		-	-
3/16"	.1875"	3/8"	SRX-13	2.05		2.10	2.45	2.76	3.26	3.50	4.28	-	6.12	-			
13/64"	.2031"	7/16"	SRX-14	-		-	2.74	-	3.52	-	-	-	-	-			
7/32"	.2188"		13/32"	SRX-15		2.19	2.24	2.73	3.06	3.62	-	-	-	6.63	-		
15/64"	.2344"		SRX-16	-		-	3.00	-	3.88	-	-	-	-	-	-		
B	.2380"		1/2"	SRX-B		-	-	4.39	-	-	-	-	-	-	-		
C	.2420"			SRX-C		-	-	4.44	-	-	-	-	-	-	-	-	
D	.2460"			SRX-D		-	-	4.59	-	-	-	-	-	-	-	-	
1/4"	.2500"			9/16"		SRX-17	2.34	2.39	2.98	3.34	3.86	4.27	4.95	5.60	7.13	-	
F	.2570"					SRX-F	-	-	4.64	-	-	-	-	-	-	-	-
G	.2610"				SRX-G	-	-	4.69	-	-	-	-	-	-	-	-	
17/64"	.2656"				SRX-18	-	-	3.52	-	4.21	-	-	-	-	7.55	-	
I	.2720"	5/8"			SRX-I	-	-	4.85	-	-	-	-	-	-	-		
J	.2770"				SRX-J	-	-	4.90	-	-	-	-	-	-	-	-	
9/32"	.2813"				11/16"	SRX-19	2.77	2.87	3.65	3.75	4.35	-	5.80	-	8.05	-	
L	.2900"		SRX-L			-	-	5.20	-	-	-	-	-	-	-	-	
M	.2950"		SRX-M			-	-	5.25	-	-	-	-	-	-	-	-	
19/64"	.2969"		3/4"			SRX-20	-	-	3.86	-	4.85	-	-	-	-	-	
N	.3020"			SRX-N		-	-	5.36	-	-	-	-	-	-	-	-	
5/16"	.3125"			5/8"		SRX-21	3.06	3.16	4.06	4.15	4.85	5.40	6.38	6.99	8.66	32.13	
P	.3230"					SRX-P	-	-	5.66	-	-	-	-	-	-	-	-
21/64"	.3281"					11/16"	SRX-22	-	-	4.35	-	5.65	-	-	-	9.37	-
Q	.3320"	SRX-Q					-	-	5.87	-	-	-	-	-	-	-	-
R	.3390"	11/16"					SRX-R	-	-	5.97	-	-	-	-	-	-	-
11/32"	.3438"				SRX-23		3.51	3.56	4.55	4.70	5.73	-	-	-	9.70	-	
23/64"	.3594"				SRX-24		-	-	4.85	-	6.13	-	-	-	-	-	-
U	.3680"				11/16"		SRX-U	-	-	6.48	-	-	-	-	-	-	-
3/8"	.3750"		SRX-25				3.71	3.75	5.05	5.24	6.19	6.77	8.35	9.18	11.88	31.61	
V	.3770"		11/16"				SRX-V	-	-	6.63	-	-	-	-	-	-	-
W	.3860"			SRX-W			-	-	6.63	-	-	-	-	-	-	-	-
X	.3970"			11/16"			SRX-X	-	-	6.99	-	-	-	-	-	-	-
Y	.4040"					SRX-Y	-	-	7.14	-	-	-	-	-	-	-	-
13/32"	.4063"					11/16"	SRX-27	4.11	4.15	5.63	5.90	7.28	-	9.60	-	13.82	-
7/16"	.4375"	SRX-29					4.46	4.55	6.19	6.43	7.87	8.62	10.70	-	15.45	34.31	
15/32"	.4688"	SRX-31					5.73	5.83	6.78	7.02	11.29	-	11.82	-	17.58	-	
1/2"	.5000"	SRX-33					5.29	5.44	7.37	7.71	9.69	10.29	12.80	-	19.02	37.98	
9/16"	.5625"	13/16"			SRX-35		-	6.72	9.17	-	11.68	-	15.25	-	21.82	-	
5/8"	.6250"	7/8"			SRX-37		-	7.79	10.76	-	13.56	-	17.60	-	24.63	-	
11/16"	.6875"	15/16"	SRX-39		-		10.26	12.69	-	17.89	-	20.76	-	28.75	-		
3/4	.7500"	1"	SRX-41		-		10.86	14.58	-	18.55	-	23.76	-	32.69	-		
7/8	.8750"	1-1/8"	SRX-45	-	23.30		27.40	-	46.55	-	65.75	-	84.85	-			
1"	1.000"	1-1/4"	SRX-47	-	24.40		27.40	-	53.95	-	69.80	-	90.35	-			



H-13 Shoulder Ejector Pins

STANDARD INCH .0003" DIAMETER TOLERANCE

SRX Nitrided (CORE 41-45 Rc)

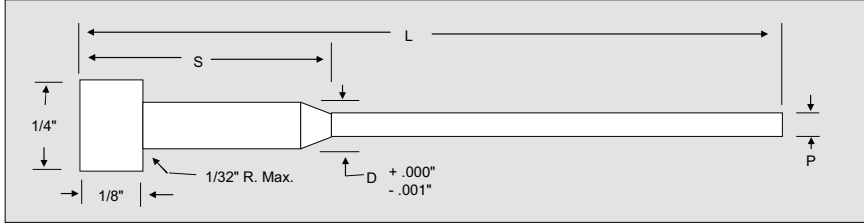

MATERIAL: H-13 HOTWORK DIE STEEL
 CORE: HARDENED THROUGHOUT TO 41-45 Rc
 SURFACE: ION NITRIDED TO 65-74 Rc

SMITH SRX Nitrided Ejector Pins are made from the finest grade of H-13 hotwork die steel. The heads are hot forged and stress relieved for uniform grain flow and high tensile strength. The core is hardened through to 41-45 Rc and the surface is ion nitrided to 65-74 Rc. Diameters are precision ground to a high surface finish (6-10 rms) and .0003" tolerance.

TOLERANCES			
P	H	T	L
-.0005"	+.000"	+.000"	+.375"
-.0008"	-.010"	-.002"	-.000"

HOW TO ORDER				
Specify:	Quantity	Catalog Number	If Oversize	Length
Examples:	24	SRX-5-2		L-6"
	48	SRX-3-2	+.005"	L-10"

STANDARD FRACTIONAL & .005" OVERSIZE DIAMETERS

P		S	SMITH CATALOG NO.	NET PRICE EACH (US\$)					Pkg. Qty.
				L-4"	L-6"	L-10"		L-14"	
NOMINAL PIN DIA.	ACTUAL PIN DIA.	SHOULDER LENGTH		STANDARD DIA.	STANDARD DIA.	STANDARD DIA.	+ .005" DIA.	STANDARD DIA.	
1/32"	.0308" .0305"	1/2"	SRX-2-1/2	-	7.23	-	-	-	12
		2"	SRX-2-2	-	7.12	-	-		
		3"	SRX-2-3	-	-	8.93	-	-	
		4"	SRX-2-4	-	-	8.93	-	-	
3/64"	.0464" .0461"	1/2"	SRX-3-1/2	4.15	4.20	5.42	5.98	6.94	
		2"	SRX-3-2	4.06	4.11	4.79	5.76	6.72	
		3"	SRX-3-3	-	-	4.79	-	-	
		4"	SRX-3-4	-	-	4.79	-	-	
1/16"	.0620" .0617"	1/2"	SRX-5-1/2	3.91	3.96	5.07	5.64	6.53	
		2"	SRX-5-2	3.81	3.87	4.83	5.42	6.17	
		3"	SRX-5-3	-	-	4.64	-	-	
		4"	SRX-5-4	-	-	4.83	-	-	
5/64"	.0776" .0773"	1/2"	SRX-6-1/2	3.91	3.96	5.07	5.64	6.62	
		2"	SRX-6-2	3.81	3.87	4.83	5.42	6.27	
		3"	SRX-6-3	-	-	4.64	-	-	
		4"	SRX-6-4	-	-	4.83	-	-	
3/32"	.0933" .0930"	1/2"	SRX-7-1/2	3.51	3.57	4.60	5.18	6.27	
		2"	SRX-7-2	3.42	3.47	4.37	4.95	6.02	
		3"	SRX-7-3	-	-	4.18	-	-	
		4"	SRX-7-4	-	-	4.37	-	-	
7/64"	.1089" .1086"	1/2"	SRX-8-1/2	3.51	3.57	4.60	5.18	6.27	
		2"	SRX-8-2	3.42	3.47	4.37	4.95	5.90	
		3"	SRX-8-3	-	-	4.18	-	-	
		4"	SRX-8-4	-	-	4.37	-	-	



H-13 Straight Ejector Pins

STANDARD INCH .0003" DIAMETER TOLERANCE

SRHX Hardened-Through (CORE 50-55 Rc)

MATERIAL: H-13 HOTWORK DIE STEEL
 CORE: HARDENED THROUGH TO 50-55 Rc
 SURFACE: ION NITRIDED TO 65-74 Rc
 HEADS ANNEALED FOR EASY MACHINING

TOLERANCES			
D	H	T	L
-.0005"	+.000"	+.000"	+.375"
-.0008"	-.010"	-.002"	-.000"

HOW TO ORDER: Specify			
Quantity	Cat. No.	(If .005" O.S.)	Length
60	SRHX-25	+.005"	L-10"
12	SRHX-9		L-6"

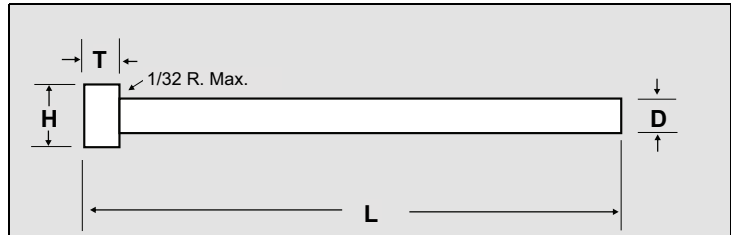

D		H	T	SMITH CATALOG NO.	NET PRICE EACH (US\$)					PKG. QTY.
					L-6"	L-10"		L-14"		
NOMINAL SIZE	DECIMAL EQUIV.	HEAD DIA.	HEAD THICK.		STANDARD DIA.	STANDARD DIA.	+.005" OVERSIZE DIA.	STANDARD DIA.	+.005" OVERSIZE DIA.	
					3/64"	.0469"	1/4"	1/8"	SRHX-3	
1/16"	.0625"	SRHX-5	4.05	4.75	5.3	-			-	
5/64"	.0781"	SRHX-6	4.05	4.75	5.30	-			-	
3/32"	.0938"	SRHX-7	3.65	4.10	4.85	-			-	
7/64"	.1094"	SRHX-8	3.65	4.10	4.85	-			-	
1/8"	.1250"	SRHX-9	1.95	2.15	2.25	2.5			2.8	
9/64"	.1406"	SRHX-10	2.15	2.35	3.15	3.05			-	
5/32"	.1563"	9/32"	5/32"	SRHX-11	2.05	2.30	2.40	2.80	3.05	
11/64"	.1719"	11/32"	3/16"	SRHX-12	2.30	2.50	3.35	3.05	-	
3/16"	.1875"	3/8"		SRHX-13	2.10	2.45	2.55	3.10	3.30	
13/64"	.2031"			SRHX-14	2.55	2.70	-	3.25	-	
7/32"	.2188"	13/32"		SRHX-15	2.30	2.70	2.95	3.35	-	
15/64"	.2344"			SRHX-16	2.85	3.00	-	3.70	-	
1/4"	.2500"	7/16"		SRHX-17	2.45	3.00	3.10	3.70	4.00	
17/64"	.2656"			SRHX-18	3.25	3.35	-	4.05	-	
9/32"	.2813"		SRHX-19	2.75	3.45	3.55	4.20	-		
19/64"	.2969"		1/2"	SRHX-20	3.65	3.80	-	4.70	-	
5/16"	.3125"	SRHX-21		3.05	3.80	3.90	4.75	5.25		
21/64"	.3281"	9/16"	SRHX-22	4.00	4.20	-	5.30	-		
11/32"	.3438"		SRHX-23	3.40	4.30	4.55	5.50	-		
23/64"	.3594"		5/8"	SRHX-24	4.40	4.75	-	5.95	-	
3/8"	.3750"	SRHX-25		3.65	4.85	5.05	6.00	6.35		
25/64"	.3906"	37/64"	1/4"	SRHX-26	5.35	5.90	-	-	-	
13/32"	.4063"	11/16"		SRHX-27	4.00	5.30	5.70	6.90	-	
27/64"	.4219"			SRHX-28	5.25	6.75	-	-	-	
7/16"	.4375"			SRHX-29	4.35	5.90	6.15	7.60	8.40	
29/64"	.4531"	45/64"		SRHX-30	5.70	7.05	-	-	-	
15/32"	.4688"			SRHX-31	5.10	6.45	6.85	9.30	-	
31/64"	.4844"			3/4"	SRHX-32	6.20	8.15	-	-	-
1/2"	.5000"		SRHX-33		5.15	6.95	10.20	9.15	9.75	



H-13 Shoulder Ejector Pins

STANDARD INCH .0003" DIAMETER TOLERANCE
STANDARD FRACTIONAL & .005" OVERSIZE DIAMETERS

SRHX Hardened-Through (CORE 50-55 Rc)

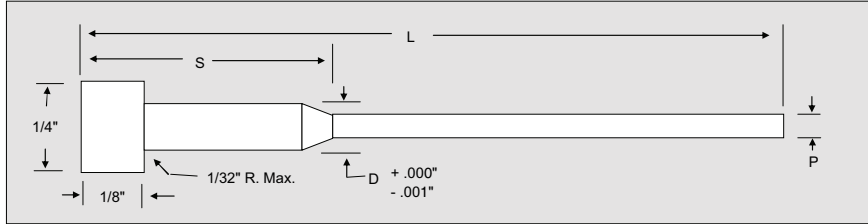

MATERIAL: H-13 HOTWORK DIE STEEL
CORE: HARDENED THROUGHOUT TO 50-55 Rc
SURFACE: ION NITRIDED TO 65-74 Rc
HEADS ANNEALED FOR EASY MACHINING

TOLERANCES			
P	H	T	L
-.0005"	+.000"	+.000"	+.375"
-.0008"	-.010"	-.002"	-.000"

HOW TO ORDER				
Specify:	Quantity	Catalog Number	If Oversize	Length
Examples:	24	SRHX-7-1/2		L-6"
	48	SRHX--5-2	+.005"	L-10"

P		S	SMITH CATALOG NO.	NET PRICE EACH (US\$)					Pkg. Qty.
				L-6"	L-10"		L-14"		
NOMINAL PIN DIA.	ACTUAL PIN DIA.	SHOULDER LENGTH		STANDARD DIA.	STANDARD DIA.	+.005" DIA.	STANDARD DIA.	+.005" DIA.	
1/32"	.0308 .0305"	1/2"	SRHX-2-1/2	7.35	-	-	-	-	12
		2"	SRHX-2-2	7.25	-	-	-	-	
		3"	SRHX-2-3	-	9.15	8.59	-	-	
		4"	SRHX-2-4	-	9.15	8.59	-	-	
3/64"	.0464 .0461"	1/2"	SRHX-3-1/2	4.25	-	-	-	-	
		2"	SRHX-3-2	4.05	4.65	5.40	-	-	
		3"	SRHX-3-3	-	5.10	6.15	-	-	
		4"	SRHX-3-4	-	5.70	6.15	-	-	
1/16"	.0620 .0617"	1/2"	SRHX-5-1/2	3.95	4.90	5.60	-	-	
		2"	SRHX-5-2	3.85	4.50	5.40	6.20	7.15	
		3"	SRHX-5-3	-	4.75	5.85	-	-	
		4"	SRHX-5-4	-	5.30	6.45	-	-	
5/64"	.0776 .0773"	1/2"	SRHX-6-1/2	3.95	4.90	5.70	-	-	
		2"	SRHX-6-2	3.85	4.50	5.10	6.20	7.15	
		3"	SRHX-6-3	-	4.75	5.85	-	-	
		4"	SRHX-6-4	-	5.30	6.45	-	-	
3/32"	.0933 .0930"	1/2"	SRHX-7-1/2	3.60	4.55	5.10	-	-	
		2"	SRHX-7-2	3.40	4.30	4.90	5.80	6.75	
		3"	SRHX-7-3	-	4.30	5.35	-	-	
		4"	SRHX-7-4	-	4.75	5.85	-	-	
7/64"	.1089 .1086"	1/2"	SRHX-8-1/2	3.60	4.55	5.10	-	-	
		2"	SRHX-8-2	3.40	4.05	4.60	5.80	6.75	
		3"	SRHX-8-3	-	4.30	5.35	-	-	
		4"	SRHX-8-4	-	4.75	5.85	-	-	



H-13 Straight Ejector Pins

EURO-METRIC

SME Nitrided Metric (CORE 41-45 Rc)

MATERIAL: H-13 HOTWORK DIE STEEL (1.2344)
CORE: HARDENED THROUGH TO 41-45 Rc
SURFACE: ION NITRIDED TO 65-74 Rc

TOLERANCES (METRIC ISO)		
PIN DIA. (D) g6		R
SIZE	TOLERANCE	
0 to 3 mm	-.002 mm -.008 mm	0.3 mm
3.5 to 6 mm	-.002 mm -.008 mm	0.3 mm
6.5 to 10 mm	-.002 mm -.008 mm	0.5 mm
11 to 18 mm	-.006 mm -.017 mm	0.8 mm
20 to 25 mm	-.006 mm -.017 mm	0.8 mm

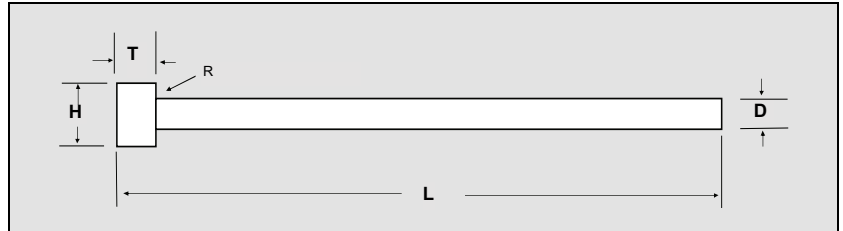

H	T	L
+ 0.0 mm - 0.2 mm	+ 0.0 mm - 0.5 mm	+ 2.0 mm - 0.0 mm

HOW TO ORDER: Specify		
Quantity	Cat. No.	Length
60	SME-2.5	L-160
12	SME-10.0	L-250

D		H	T	SMITH CATALOG NO.	NET PRICE EACH (US\$)					PKG. QTY.
PIN DIA.		HEAD DIA.	HEAD THICK.		L-160	L-250	L-315	L-400	L-500	
NOMINAL SIZE	INCH CONVERSION									
2.0	0.0787	4	2	SME-2.0	3.32	3.42	-	-	-	12
2.5	0.0984	5	2	SME-2.5	3.37	3.67	4.28	-	-	
3.0	0.1181	6	3	SME-3.0	2.60	3.83	4.08	4.56	6.00	
3.5	0.1378	7	3	SME-3.5	3.98	4.69	5.66	5.19	6.30	
4.0	0.1575	8	3	SME-4.0	2.81	4.18	4.49	5.30	6.50	
4.5	0.1772	8	3	SME-4.5	4.39	5.51	6.27	6.27	7.40	
5.0	0.1969	10	3	SME-5.0	3.01	3.88	4.95	6.14	7.40	
5.5	0.2165	10	3	SME-5.5	4.64	5.87	6.73	6.42	7.70	
6.0	0.2362	12	5	SME-6.0	3.77	5.41	6.27	7.88	8.99	
6.5	0.2559	12	5	SME-6.5	5.15	7.19	8.31	8.85	11.69	
7.0	0.2756	12	5	SME-7.0	5.51	7.85	8.98	8.85	11.69	
8.0	0.3150	14	5	SME-8.0	4.90	7.19	8.52	10.61	11.86	
9.0	0.3543	14	5	SME-9.0	6.63	10.10	11.63	11.16	15.28	
10.0	0.3937	16	5	SME-10.0	5.76	8.67	10.15	12.50	15.28	
11.0	0.4331	16	5	SME-11.0	8.77	13.46	15.91	15.40	22.16	
12.0	0.4724	20	7	SME-12.0	6.78	9.79	13.46	14.41	20.68	
12.5	0.4921	20	7	SME-12.5	8.26	11.73	15.35	15.40	22.16	
14.0	0.5512	22	7	SME-14.0	8.57	12.65	18.45	26.68	-	6
16.0	0.6299	22	7	SME-16.0	9.59	14.59	19.00	27.55	-	
18.0	0.7087	26	7	SME-18.0	-	19.18	39.75	58.00	-	
20.0	0.7874	26	8	SME-20.0	-	22.44	40.50	59.45	-	4
25.0	0.9843	32	10	SME-25.0	-	39.22	56.75	83.52	-	2



Standard H-13 Core Pins

30 STANDARD FRACTIONAL DIAMETERS

SRC Standard Hardness (30-35 Rc)

SRCX High Hardness (50-55 Rc)

TOLERANCES		
D	PIN DIA.	+ .0008" + .0003"
H	HEAD DIA.	+ .000" - .010"
T	HEAD THICKNESS	+ .000" - .002"
L	OVERALL LENGTH	+ .375" - .000"

SRCX 6"-10"
HEADS ANNEALED

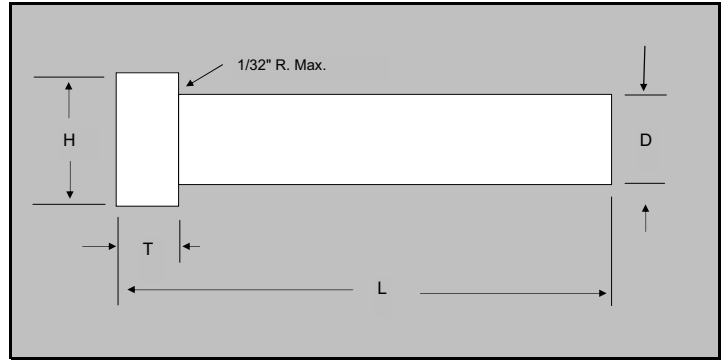

HOW TO ORDER			
Specify:	Qty.	Catalog No.	L-Length
Examples:	24	SRC-19	L-6"
	12	SRCX-17	L-3"

STANDARD HARDNESS				D	H	T	HIGH HARDNESS			PKG. QTY.	
30-35 Rc							50-55 Rc				
SMITH CAT. NO.	NET PRICE EACH (US\$)			BODY DIA.	HEAD DIA.	HEAD DIA.	SMITH CAT. NO.	NET PRICE EACH (US\$)			
	L-3"	L-6"	L-10"					L-3"	L-6"	L-10"	
SRC- 3	4.90	5.51	-	3/64	1/4	1/8	SRCX- 3	5.10	5.76	-	12 PINS
SRC- 5	4.64	5.15	-	1/16	1/4	1/8	SRCX- 5	4.85	5.41	-	
SRC- 6	4.23	4.64	-	5/64	1/4	1/8	SRCX- 6	4.44	4.90	-	
SRC- 7	3.62	3.72	4.34	3/32	1/4	1/8	SRCX- 7	3.83	3.98	4.69	
SRC- 8	3.72	3.88	4.59	7/64	1/4	1/8	SRCX- 8	3.93	4.08	4.90	
SRC- 9	2.24	2.30	3.06	1/8	1/4	1/8	SRCX- 9	2.40	2.50	3.21	
SRC- 10	2.24	2.35	3.06	9/64	1/4	1/8	SRCX- 10	2.40	2.60	3.21	
SRC- 11	2.30	2.40	3.11	5/32	9/32	5/32	SRCX- 11	2.50	2.60	3.21	
SRC- 12	2.30	2.40	3.21	11/64	11/32	3/16	SRCX- 12	2.55	2.65	3.42	
SRC- 13	2.35	2.45	3.26	3/16	3/8	3/16	SRCX- 13	2.55	2.70	3.42	
SRC- 14	2.40	2.50	3.32	13/64	3/8	3/16	SRCX- 14	2.60	2.75	3.57	
SRC- 15	2.45	2.60	3.42	7/32	13/32	3/16	SRCX- 15	2.65	2.81	3.57	
SRC- 16	3.42	3.98	-	15/64	13/32	3/16	SRCX- 16	3.62	4.23	-	
SRC- 17	2.65	2.75	3.67	1/4	7/16	3/16	SRCX- 17	2.86	3.01	3.88	
SRC- 18	3.67	4.23	-	17/64	7/16	1/4	SRCX- 18	3.93	4.54	-	
SRC- 19	2.91	3.01	4.03	9/32	7/16	1/4	SRCX- 19	3.16	3.32	4.34	
SRC- 20	3.98	4.54	-	19/64	1/2	1/4	SRCX- 20	4.23	4.85	-	
SRC- 21	3.21	3.32	4.44	5/16	1/2	1/4	SRCX- 21	3.47	3.62	4.79	
SRC- 22	4.23	4.85	-	21/64	9/16	1/4	SRCX- 22	4.54	5.20	-	
SRC- 23	3.47	3.62	4.79	11/32	9/16	1/4	SRCX- 23	3.77	3.98	5.30	
SRC- 24	4.64	5.25	-	23/64	5/8	1/4	SRCX- 24	4.90	5.61	-	
SRC- 25	3.88	4.03	5.30	3/8	5/8	1/4	SRCX- 25	4.13	4.39	5.81	
SRC- 27	4.34	4.54	5.76	13/32	11/16	1/4	SRCX- 27	4.64	4.95	6.32	
SRC- 29	4.69	4.85	6.32	7/16	11/16	1/4	SRCX- 29	5.00	5.20	6.94	
SRC- 31	5.20	5.41	6.89	15/32	3/4	1/4	SRCX- 31	5.56	5.97	7.60	
SRC- 33	5.56	5.76	7.40	1/2	3/4	1/4	SRCX- 33	5.87	6.27	8.21	
SRC- 35	-	6.89	9.18	9/16	13/16	1/4	SRCX- 35	-	7.50	10.00	
SRC- 37	-	8.21	10.76	5/8	7/8	1/4	SRCX- 37	-	8.77	11.88	
SRC- 39	-	13.26	-	11/16	15/16	1/4	SRCX- 39	-	14.18	-	
SRC- 41	-	11.12	14.69	3/4	1	1/4	SRCX- 41	-	12.09	16.32	



H-13 Ejector Blades

U.S. STANDARD INCH

SBE (50-54 Rc)

MATERIAL: H-13 HOTWORK DIE STEEL
 BLADE HARDNESS: 50-54 Rc
 HEADS ANNEALED FOR EASY MACHINING

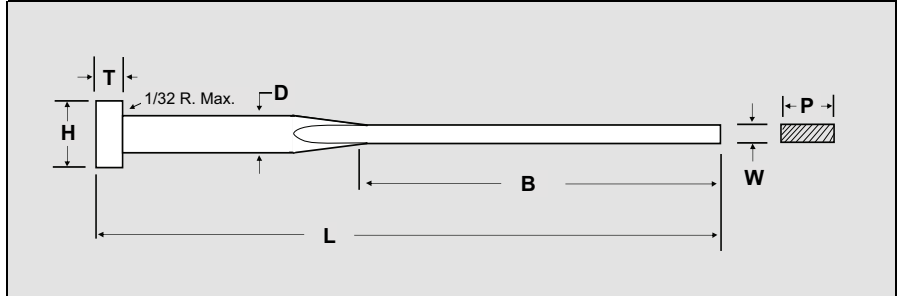

HOW TO ORDER: Specify		
Quantity	Cat. No.	Length
60	SBE11-324 - 6	
12	SBE17-624 - 9	

SMITH CATALOG NO.	W	P	D	B	H	T	NET PRICE EACH (US\$)									
							L - STANDARD OVERALL LENGTH									
							+0.000" -0.0003"									
							+0.000" -0.002"									
BLADE THICK.	BLADE WIDTH	PIN DIA.	BLADE LENGTH	HEAD DIA.	HEAD THICK.	5"		6"	6-3/8"	7-3/8"	8"	8-3/8"	9-3/8"	10-3/8"		
							- 5	- 6	- 7	- 8	- 9	- 10				
SBE9-244	.024"	.100"	.125"	4-3/8"	1/4"	1/8"	-	-	20.77	-	-	-	-	-	-	
SBE9-323	.032"	.100"	.125"	3"			19.63	20.01	-	-	-	-	-	-		
SBE9-324	.032"	.100"	.125"	4-3/8"			-	-	20.77	20.77	-	-	-	-		
SBE9-463	.046"	.100"	.125"	3"			19.63	20.01	-	-	-	-	-	-		
SBE9-464	.046"	.100"	.125"	4-3/8"			-	-	20.77	20.77	-	-	-	-		
SBE11-244	.024"	.140"	.156"	4-3/8"	9/32"	5/32"	-	-	20.77	-	-	-	-	-	-	
SBE11-323	.032"	.140"	.156"	3"			-	20.01	-	-	20.85	-	-	-		
SBE11-324	.032"	.140"	.156"	4-3/8"			-	-	20.77	20.77	-	21.62	-	-		
SBE11-463	.046"	.140"	.156"	3"			-	20.01	-	-	23.16	-	-	-		
SBE11-464	.046"	.140"	.156"	4-3/8"			-	-	20.77	20.77	-	21.62	-	-		
SBE13-244	.024"	.172"	.187"	4-3/8"	3/8"	3/16"	-	-	25.63	-	-	-	-	-	-	
SBE13-323	.032"	.172"	.187"	3"			-	24.86	-	-	25.70	-	-	-		
SBE13-324	.032"	.172"	.187"	4-3/8"			-	-	25.63	25.63	-	26.32	-	-		
SBE13-463	.046"	.172"	.187"	3"			-	24.86	-	-	25.70	-	-	-		
SBE13-464	.046"	.172"	.187"	4-3/8"			-	-	25.63	25.63	-	26.32	-	-		
SBE13-623	.062"	.172"	.187"	3"			-	24.86	-	-	25.70	-	-	-		
SBE13-624	.062"	.172"	.187"	4-3/8"			-	-	25.63	25.63	-	26.32	-	-		
SBE17-323	.032"	.234"	.250"	3"	7/16"	3/16"	25.40	27.23	-	-	27.66	-	-	-	-	
SBE17-324	.032"	.234"	.250"	4-3/8"			-	-	28.00	28.00	-	28.76	29.61	30.41		
SBE17-463	.046"	.234"	.250"	3"			25.40	27.23	-	-	27.66	-	-	-		
SBE17-464	.046"	.234"	.250"	4-3/8"			-	-	28.00	28.00	-	36.41	29.61	30.41		
SBE17-623	.062"	.234"	.250"	3"			25.40	27.23	-	-	27.66	-	-	-		
SBE17-624	.062"	.234"	.250"	4-3/8"			-	-	28.00	28.00	-	28.76	29.42	30.41		
SBE21-324	.032"	.296"	.312"	4-3/8"	1/2"	1/4"	-	-	32.02	33.58	-	34.20	35.04	35.96		
SBE21-464	.046"	.296"	.312"	4-3/8"			-	-	31.18	32.74	-	33.35	34.20	35.04		
SBE21-624	.062"	.296"	.312"	4-3/8"			-	-	30.34	31.90	-	33.09	33.93	35.04		
SBE21-784	.078"	.296"	.312"	4-3/8"			-	-	29.61	31.25	-	32.63	33.74	34.58		
SBE25-324	.032"	.359"	.375"	4-3/8"	5/8"	1/4"	-	-	36.18	41.31	-	37.94	38.40	39.21		
SBE25-464	.046"	.359"	.375"	4-3/8"			-	-	35.54	36.53	-	37.10	37.49	38.33		
SBE25-624	.062"	.359"	.375"	4-3/8"			-	-	35.16	36.15	-	36.87	37.03	37.87		
SBE25-784	.078"	.359"	.375"	4-3/8"			-	-	34.70	35.69	-	36.23	36.69	37.53		
SBE33-625	.062"	.484"	.500"	5-3/8"	3/4"	1/4"	-	-	-	-	-	53.78	54.62	55.43		
SBE33-785	.078"	.484"	.500"	5-3/8"			-	-	-	-	-	-	53.78	54.62	55.43	



H-13 Ejector Sleeves

STANDARD INCH

SSL Nitrided O.D. & I.D. (65-74 Rc)

Material: H-13, Nitrided O.D. & I.D. 65-74 Rc

TOLERANCES				
I.D.	O.D.	HEAD DIA.	HEAD THICK.	O.A.L.
B	D	H	T	L
+0.0005"	-0.0003"	+0.000"	+0.000"	+0.125"
-0.0000"	-0.0008"	-0.010"	-0.002"	-0.000"

HOW TO ORDER: Specify		
Quantity	Catalog No.	Length
6	SSL-25	L-5"
24	SSL-17	L7"

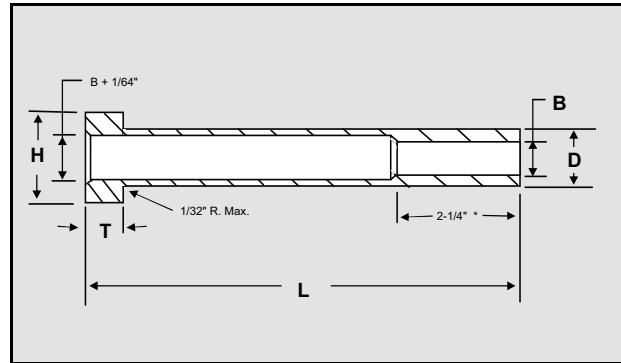

SMITH CATALOG NUMBER	B	D	H	T	NET PRICE EACH (US\$)				
					LENGTHS				
					L-3"	L-4"	L-5"	L-6"	L-7"
SSL-13	3/32"	3/16"	3/8"	3/16"	26.35	28.65	31.45	33.95	37.00
SSL-15	1/8"	7/32"	13/32"	3/16"	25.10	27.90	30.90	33.45	36.50
SSL-17	5/32"	1/4"	7/16"	3/16"	-	21.30	22.30	24.10	26.35
SSL-21	3/16"	5/16"	1/2"	1/4"	-	21.80	23.05	25.10	27.65
SSL-23	7/32"	11/32"	9/16"	1/4"	-	22.05	23.60	25.60	28.40
SSL-25	1/4"	3/8"	5/8"	1/4"	-	22.55	24.10	26.35	28.90
SSL-29	5/16"	7/16"	11/16"	1/4"	-	23.05	25.60	28.15	30.90
SSL-33	3/8"	1/2"	3/4"	1/4"	-	23.60	27.90	30.40	33.45
SSL-37	7/16"	5/8"	7/8"	1/4"	-	25.35	30.40	35.50	38.50
SSL-39	1/2"	11/16"	15/16"	1/4"	-	26.60	31.45	37.00	40.55
SSL-41	9/16"	3/4"	1"	1/4"	-	33.00	36.50	40.00	44.00
SSL-45	5/8"	7/8"	1-1/8"	1/4"	-	37.50	41.00	45.00	49.00
SSL-47	3/4"	1"	1-1/4"	1/4"	-	41.50	45.50	49.50	54.00

SMITH CATALOG NUMBER	B	D	H	T	NET PRICE EACH (US\$)				
					LENGTHS				
					L-8"	L-9"	L-10"	L-11"	L-12"
SSL-13	3/32"	3/16"	3/8"	3/16"	43.55	-	53.80	-	-
SSL-15	1/8"	7/32"	13/32"	3/16"	40.25	-	49.00	-	-
SSL-17	5/32"	1/4"	7/16"	3/16"	28.90	31.95	36.00	-	-
SSL-21	3/16"	5/16"	1/2"	1/4"	30.40	33.45	37.50	41.50	46.50
SSL-23	7/32"	11/32"	9/16"	1/4"	31.45	35.50	39.05	-	-
SSL-25	1/4"	3/8"	5/8"	1/4"	31.95	36.00	40.05	44.50	49.50
SSL-29	5/16"	7/16"	11/16"	1/4"	34.45	38.50	42.55	47.50	52.50
SSL-33	3/8"	1/2"	3/4"	1/4"	37.00	44.05	45.60	50.50	56.00
SSL-37	7/16"	5/8"	7/8"	1/4"	42.55	46.60	51.20	56.50	62.00
SSL-39	1/2"	11/16"	15/16"	1/4"	44.60	49.15	54.20	59.50	65.00
SSL-41	9/16"	3/4"	1"	1/4"	48.00	53.00	57.50	63.00	68.50
SSL-45	5/8"	7/8"	1-1/8"	1/4"	53.50	58.50	63.50	69.50	75.00
SSL-47	3/4"	1"	1-1/4"	1/4"	58.50	64.00	69.50	75.00	81.50

* SSL-13 and SSL-15 have 1-3/4" bearing length.



JIS Metric Pins

SEPH—M-2 Straight Ejector Pins

Hardened-Through HSS (59-61 Rc)

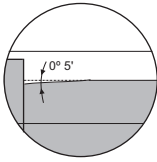

NOTE: Under Head—Manufacturing Taper 0° 5'

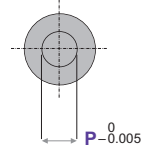
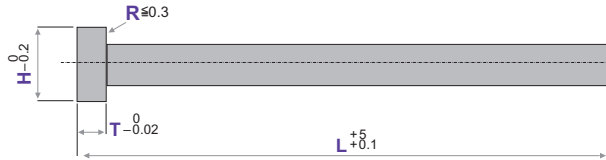

Code No.		L					T	H
Code	P							
	0.2	50	60					
	0.3	50	60				2	
	0.4	50	60	100				
	0.5		60	100				
	0.6 0.7 0.8 0.9		100	150				
	1 1.1 1.2 1.3 1.4		100	150	200		3	
	1.5 1.6		100	150	200	250		
	1.7 1.8 1.9		100	150	200			
	2		100	150	200	250	300	
	2.1		100	150	200	250		
	2.2 2.3 2.4		100	150	200			
	2.5		100	150	200	250	300	
	2.6		100	150	200	250		
	2.7 2.8 2.9		100	150	200			
	3		100	150	200	250	300	350
	3.1		100	150	200	250		
	3.2 3.3 3.4		100	150	200			
	3.5		100	150	200	250	300	350
	3.6		100	150	200	250		
	3.7 3.8 3.9		100	150	200			
	4		100	150	200	250	300	350
	4.1		100	150	200	250		
	4.2		100	150	200			
	4.3		100	150	200			
	4.4		100	150	200			
	4.5		100	150	200	250	300	350
SEPH	4.6		100	150	200	250		
	4.7 4.8 4.9		100	150	200			
	5		100	150	200	250	300	350
	5.1		100	150	200	250		
	5.5		100	150	200	250	300	350
	5.6		100	150	200	250		
	6		100	150	200	250	300	350
	6.1		100	150	200	250		
	6.5		100	150	200	250	300	350
	6.6		100	150	200	250		
	7		100	150	200	250	300	350
	7.1		100	150	200	250		
	7.5 7.6		100	150	200	250		
	8		100	150	200	250	300	350
	8.1		100	150	200	250		
	8.5 8.6		100	150	200	250		
	9		100	150	200	250	300	350
	9.1		100	150	200	250		
	9.5 9.6		100	150	200	250		
	10		100	150	200	250	300	350
	10.1		100	150	200	250		
	10.5 10.6		100	150	200	250		
	11		100	150	200	250	300	
	11.1		100	150	200	250		
	11.5		100	150	200	250		
	11.6		100	150	200	250		
	12		100	150	200	250	300	350
	12.1		150	200	250			

ORDER	Code No.	L	T
	SEPH 2	- 150	- 4



JIS Metric Pins

SEPS—M-2 Straight Ejector Pins

Hardened-Through HSS (59-61 Rc)

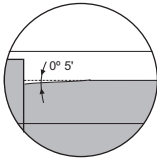

NOTE: Under Head—Manufacturing Taper 0° 5'

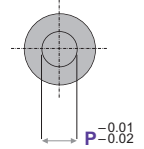
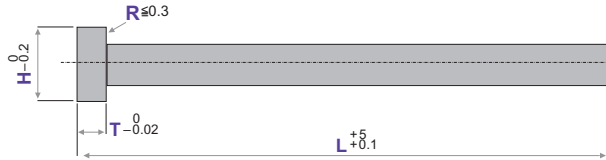

Code No.		L					T	H
Code	P							
	0.2 0.3	60						2
	0.4	60	100					
	0.5	60	100					
	0.6 0.7 0.8 0.9	100	150					
	1 1.1 1.2 1.3 1.4	100	150	200				3
	1.5	100	150	200	250			
	1.6	100	150	200	250			
	1.7 1.8 1.9	100	150	200				
	2	100	150	200	250	300	4	4
	2.1	100	150	200	250			
	2.2 2.3 2.4	100	150	200				
	2.5	100	150	200	250	300		5
	2.6	100	150	200	250			
	2.7 2.8 2.9	100	150	200				
	3	100	150	200	250	300	350	6
	3.1	100	150	200	250			
	3.2 3.3 3.4	100	150	200				
	3.5	100	150	200	250	300	350	4 • 6
	3.6	100	150	200	250			
	3.7 3.8 3.9	100	150	200			4	7
	4	100	150	200	250	300	350	4 • 6
	4.1	100	150	200	250			
	4.2	100	150	200			4	
	4.3 4.4	100	150	200				
	4.5	100	150	200	250	300	350	4 • 6
	4.6	100	150	200	250			
	4.7 4.8 4.9	100	150	200			4	9
SEPS	5	100	150	200	250	300	350	4 • 6
	5.1	100	150	200	250		4	
	5.5	100	150	200	250	300	350	4 • 6
	5.6	100	150	200	250		4	
	6	100	150	200	250	300	350	4 • 6
	6.1	100	150	200	250		4	
	6.5	100	150	200	250	300	350	4 • 8
	6.6	100	150	200	250		4	
	7	100	150	200	250	300	350	4 • 8
	7.1	100	150	200	250		4	
	7.5	100	150	200	250		4 • 8	
	7.6	100	150	200	250		4	
	8	100	150	200	250	300	350	4 • 8
	8.1	100	150	200	250		4	
	8.5	100	150	200	250		4 • 8	
	8.6	100	150	200	250		4	
	9	100	150	200	250	300	350	4 • 8
	9.1	100	150	200	250		4	
	9.5 9.6	100	150	200	250			
	10	100	150	200	250	300	350	4 • 8
	10.1	100	150	200	250		4	15
	10.5	100	150	200	250		4 • 8	
	10.6	100	150	200	250		4	
	11	100	150	200	250	300		4 • 8
	11.1	100	150	200	250			
	11.5 11.6	100	150	200	250		4	16
	12		150	200	250	300	350	4 • 8

ORDER	Code No.	L	T
	SEPS 2	150	4



JIS Metric Pins

M-2 Straight Ejector Pins

PRICE	1~49	50~100	101~
	100%	95%	Per Quote

SEPH

Code No.		@ / P (1~49P)							
Code	P	L50	L60	L100	L150	L200	L250	L300	L350
SEPH	0.2	12.50	12.50	—	—	—	—	—	—
	0.3	8.40	8.40	—	—	—	—	—	—
	0.4	6.70	6.70	6.70	—	—	—	—	—
	0.5	—	5.00	5.00	—	—	—	—	—
	0.6	—	—	2.40	4.20	—	—	—	—
	0.7	—	—	2.40	4.10	—	—	—	—
	0.8 0.9	—	—	2.20	2.50	—	—	—	—
	1 1.1	—	—	1.70	1.90	3.10	—	—	—
	1.2 1.3 1.4	—	—	1.50	1.70	2.40	—	—	—
	1.5	—	—	1.50	1.70	2.30	3.80	—	—
	1.6 1.7 1.8 1.9	—	—	1.50	1.70	2.00	4.00	—	—
	2	—	—	1.50	1.70	2.00	3.20	4.30	—
	2.1 2.2 2.3 2.4	—	—	1.70	2.00	2.10	4.20	—	—
	2.5	—	—	1.70	2.00	2.10	3.30	4.40	—
	2.6 2.7 2.8 2.9	—	—	1.70	2.10	2.20	4.40	—	—
	3	—	—	1.70	2.10	2.30	3.90	5.10	6.70
	3.1 3.2 3.3 3.4	—	—	2.20	2.60	2.80	4.30	—	—
	3.5	—	—	2.20	2.60	2.80	4.20	5.60	7.20
	3.6 3.7 3.8 3.9	—	—	2.40	2.80	3.00	4.60	—	—
	4	—	—	2.40	2.80	3.00	4.50	5.80	7.60
	4.1	—	—	3.80	4.60	4.90	6.10	—	—
	4.2 4.3 4.4	—	—	4.00	4.10	4.50	—	—	—
	4.5	—	—	2.80	2.90	3.20	5.30	6.70	8.30
	4.6	—	—	4.60	4.80	5.20	7.10	—	—

Code No.		@ / P (1~49P)						
Code	P	L100	L150	L200	L250	L300	L350	
SEPH	4.7 4.8 4.9	4.80	5.10	5.50	—	—	—	
	5	2.80	2.90	3.20	5.30	6.80	8.40	
	5.1	4.60	4.80	5.20	7.10	—	—	
	5.5	2.90	3.10	3.50	5.60	7.30	8.70	
	5.6	4.80	5.10	5.60	8.20	—	—	
	6	2.90	3.10	3.50	6.00	7.60	9.00	
	6.1	4.80	5.10	5.60	8.20	—	—	
	6.5	3.10	3.50	3.80	6.50	8.20	11.30	
	6.6	5.10	5.60	6.30	9.80	—	—	
	7	3.10	3.50	3.80	6.90	9.00	11.60	
	7.1	5.10	5.60	6.30	9.80	—	—	
	7.5	5.70	5.60	6.20	10.30	—	—	
	7.6	8.30	8.90	9.40	10.70	—	—	
	8	4.50	4.70	5.30	8.00	10.00	13.00	
	8.1	7.10	7.60	8.40	10.30	—	—	
	8.5 8.6	9.80	10.00	10.70	12.20	—	—	
	9	5.00	5.10	5.70	8.70	11.60	13.60	
	9.1	7.70	8.20	9.00	10.90	—	—	
	9.5 9.6	10.10	10.60	11.10	12.50	—	—	
	10	5.50	5.90	6.60	9.20	13.30	15.00	
	10.1	8.70	9.40	10.50	11.90	—	—	
	10.5 10.6 11 11.1	10.60	11.70	12.30	14.40	15.90	—	
	11.5 11.6	11.70	12.30	13.20	15.80	—	—	
	12	7.30	7.70	8.60	12.90	17.90	19.90	
12.1	—	12.50	13.80	16.30	—	—		

PRICE	1~49	50~100	101~
	100%	95%	Per Quote

SEPS

Code No.		@ / P (1~49P)						
Code	P	L60	L100	L150	L200	L250	L300	L350
SEPS	0.2	12.40	—	—	—	—	—	—
	0.3	8.40	—	—	—	—	—	—
	0.4	6.70	6.70	—	—	—	—	—
	0.5	5.00	5.00	—	—	—	—	—
	0.6	—	2.40	4.20	—	—	—	—
	0.7	—	2.40	4.10	—	—	—	—
	0.8	—	2.20	2.50	—	—	—	—
	0.9	—	2.10	2.50	—	—	—	—
	1 1.1	—	1.70	1.90	3.10	—	—	—
	1.2 1.3 1.4	—	1.50	1.70	2.40	—	—	—
	1.5	—	1.50	1.70	2.30	3.80	—	—
	1.6 1.7 1.8 1.9	—	1.50	1.70	2.00	4.00	—	—
	2	—	1.50	1.70	2.00	3.20	4.30	—
	2.1 2.2 2.3 2.4	—	1.70	2.00	2.10	4.20	—	—
	2.5	—	1.70	2.00	2.10	3.30	4.40	—
	2.6 2.7 2.8 2.9	—	1.70	2.10	2.20	4.40	—	—
	3	—	1.70	2.10	2.30	3.90	5.10	6.70
	3.1 3.2 3.3 3.4	—	2.20	2.60	2.80	4.30	—	—
	3.5	—	2.20	2.60	2.80	4.20	5.60	7.20
	3.6 3.7 3.8 3.9	—	2.40	2.80	3.00	4.60	—	—
	4	—	2.40	2.80	3.00	4.50	5.80	7.60
	4.1	—	3.90	4.60	4.90	6.10	—	—
	4.2 4.3 4.4	—	3.90	4.10	4.50	—	—	—
	4.5	—	2.80	2.90	3.20	5.30	6.70	8.30
4.6	—	4.60	4.80	5.20	7.10	—	—	

Code No.		@ / P (1~49P)						
Code	P	L100	L150	L200	L250	L300	L350	
SEPS	4.7 4.8 4.9	4.80	5.10	5.50	—	—	—	
	5	2.80	2.90	3.20	5.30	6.80	8.30	
	5.1	4.60	4.80	5.20	7.10	—	—	
	5.5	2.90	3.10	3.50	5.60	7.30	8.60	
	5.6	4.80	5.10	5.60	8.10	—	—	
	6	2.90	3.10	3.50	6.00	7.60	8.90	
	6.1	4.80	5.10	5.60	8.10	—	—	
	6.5	3.10	3.50	3.80	6.50	8.10	11.30	
	6.6	5.10	5.60	6.30	9.80	—	—	
	7	3.10	3.50	3.80	6.90	8.90	11.50	
	7.1	5.10	5.60	6.30	9.80	—	—	
	7.5	5.70	5.50	6.10	10.30	—	—	
	7.6	8.30	8.90	9.40	10.70	—	—	
	8	4.50	4.70	5.20	8.00	9.80	12.90	
	8.1	7.10	7.60	8.30	10.30	—	—	
	8.5	9.80	10.00	10.70	11.90	—	—	
	8.6	9.80	10.00	10.70	12.20	—	—	
	9	5.00	5.10	5.70	8.60	11.50	13.50	
	9.1	7.70	8.20	9.00	10.90	—	—	
	9.5 9.6	10.10	10.30	11.10	12.50	—	—	
	10	5.50	5.80	6.50	9.20	13.10	14.80	
	10.1	8.60	9.40	10.50	11.80	—	—	
	10.5 10.6 11 11.1	10.60	11.20	12.20	14.40	15.30	—	
	11.5 11.6	11.70	12.30	13.20	15.80	—	—	
12	—	7.70	8.50	12.90	17.90	19.70		



JIS Metric Pins

SESH—M-2 Shoulder Ejector Pins

Hardened-Through HSS (59-61 Rc)

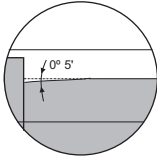

NOTE: Under Head—Manufacturing Taper 0° 5'

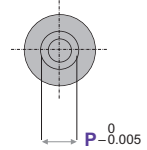
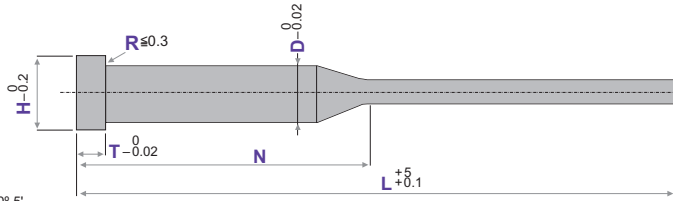

Code No.		L	in 0.1		N	T	H
Code	D		P				
SESH	1	50	0.3	~ 0.6	15		2
		60	0.3	~ 0.8	20 35		
		100	0.3	~ 0.8	40 50 60		
	1.5	60	0.3	~ 0.5	20 35		3
		100	0.3	~ 1.2	40 50 60		
		150	0.5	~ 1.2	50 70 90		
	2	200	0.6	~ 1.2	70 100		4
		100	0.7	~ 1.8	(25) 40 50 60		
		150	0.7	~ 1.8	40 50 70 90		
	2.5	200	0.7	~ 1.8	70 80 100		4
		150	0.8	~ 2.1	50 70 90		
		200	0.8	~ 2.1	70 80 100		
	3	200	1.0	~ 2.6	50 70 90		5
		150	1.0	~ 2.6	70 80 100		
		250	2.4	~ 2.6	105		
		D	L	P	N	T	H
	4	150	2.0	2.5 3.0	50 70		7
		200	2.0	2.5 3.0	70 100		
		250	2.0	2.5 3.0	100 125		
	4.5	150	2.0	2.5	50 70		6
		200	2.0	2.5	70 100		
		250	2.0	2.5	100 125		
	5	150		3.0	50 70		9
		200		3.0	70 100		
250			3.0	100 125			

ORDER	Code No.	L	P	N
	SESH 2	150	0.7	50



JIS Metric Pins

SESS—M-2 Shoulder Ejector Pins

Hardened-Through HSS (59-61 Rc)

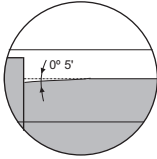

NOTE: Under Head—Manufacturing Taper 0° 5'

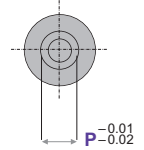
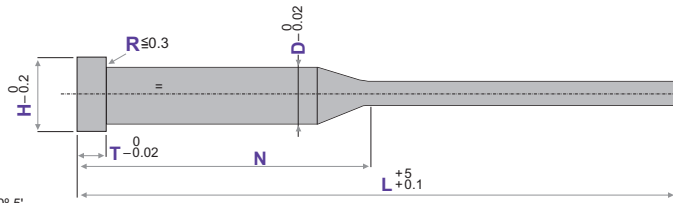

Code No.	L	P	N	T	H	
Code	D					
SESS	1	60	0.6 0.7 0.8	20 35		
		100	0.6 0.7 0.8	40 50 60		
	1.5	100	0.6 0.7 0.8 0.9 1.0 1.2	40 50 60		3
		150	0.6 0.7 0.8 1.0	50 70		
	2	150	0.9 1.2	50 70 90		
		100	0.7 0.8 0.9 1.0 1.1 1.2 1.3 1.4 1.5 1.6 1.8	40 50 60		
		150	0.7 0.8 1.0 1.2 1.5	40 50 70 90		
		150	0.9 1.1 1.3 1.4 1.6 1.8	40 50 70 90		4
		200	0.8 1.0 1.2 1.5	70 100		
		200	0.7 0.9 1.1 1.3 1.4 1.6 1.8	70 80 100		4
	2.5	150	0.8 1.0 1.2 1.5	50 70		4
		150	0.9 1.1 1.3 1.4 1.6 1.7 1.8 1.9 2.0 2.1	50 70 90		
		200	0.8 1.0 1.2 1.5	70 100		5
		200	0.9 1.1 1.3 1.4 1.6 1.7 1.8 1.9 2.0 2.1	70 80 100		
	3	150	1.0 1.1 1.2 1.3 1.4 1.5 1.6 1.7 1.8 1.9 2.0 2.1 2.2 2.3 2.4 2.5 2.6	50 70 90		
		200	1.0 1.1 1.2 1.3 1.4 1.5 1.6 1.7 1.8 1.9 2.0 2.1 2.2 2.3 2.4 2.5 2.6	70 80 100		
		250	1.0 1.2 1.5	105		
		250	1.3 1.4	105		6
		300	1.0 1.2 1.5	155		
	4	150	1.3 1.4	155		
		150	2.0 2.5 3.0	50 70		
		200	2.0 2.5 3.0	70 100		7
	4.5	250	2.0 2.5 3.0	100 125		
		150	2.0 2.5	50 70		
		200	2.0 2.5	70 100		
	5	250	2.0 2.5	100 125		6
		150	3.0	50 70		
		200	3.0	70 100		9
		250	3.0	100 125		

ORDER	Code No.	L	P	N
	SESS 2	150	0.7	50



JIS Metric Pins

M-2 Shoulder Ejector Pins

PRICE	1~49	50~100	101~
	100%	95%	Per Quote

SESH

Code No.		P	@ / P (1~49P)				
Code	D		L50	L60	L100	L150	L200
SESH	1	0.3	12.90	13.80	14.00	—	—
		0.4	12.00	12.80	12.80	—	—
		0.5	9.50	10.00	10.00	—	—
		0.6	4.30	4.60	4.60	—	—
		0.7 0.8	—	4.60	4.60	—	—
	1.5	0.3	—	4.10	4.50	—	—
		0.4	—	3.90	4.30	—	—
		0.5	—	3.70	4.10	4.20	—
		0.6	—	—	3.30	3.50	4.30
		0.7	—	—	3.30	3.50	4.90
		0.8	—	—	3.30	3.50	4.30
		0.9	—	—	3.30	3.60	4.90
		1.0 1.1 1.2	—	—	3.30	3.50	4.30
		0.7	—	—	2.70	2.80	3.10
		0.8	—	—	2.70	2.80	3.00
	2	0.9	—	—	2.70	2.80	3.10
		1.0	—	—	2.70	2.80	3.00
		1.1	—	—	2.70	2.80	3.10
		1.2	—	—	2.70	2.80	3.00
		1.3 1.4	—	—	2.70	2.80	3.10
		1.5	—	—	2.70	2.80	3.00
		1.6 1.7 1.8	—	—	2.70	2.80	3.10
		0.8	—	—	—	2.80	3.10
	2.5	0.9	—	—	—	2.80	3.00

Code No.		P	@ / P (1~49P)			
Code	D		L50	L200	L250	
SESH	2.5	1.0	2.80	3.00	—	
		1.1	2.80	3.10	—	
		1.2	2.80	3.00	—	
		1.3	2.80	3.10	—	
		1.4	2.80	3.10	—	
		1.5	2.80	3.00	—	
		1.6 1.7	2.80	3.10	—	
		1.8	2.80	3.10	—	
		1.9	2.80	3.10	—	
		2.0	2.80	3.00	—	
	3	2.1	2.80	3.10	—	
		1.0 1.1	3.00	3.40	—	
		1.2	3.00	3.30	—	
		1.3 1.4	3.10	3.40	—	
		1.5	3.00	3.30	—	
		1.6 1.7	3.10	3.40	—	
		1.8	3.00	3.30	—	
		1.9	3.10	3.40	—	
		2.0	3.00	3.30	—	
		2.1 2.2 2.3	3.10	3.40	—	
	4	2.4 2.5 2.6	3.10	3.40	5.40	
		2.0 2.5 3.0	4.50	4.70	6.10	
		4.5	2.0 2.5	5.10	5.40	6.10
		5	3.0	5.70	6.20	8.10

PRICE	1~49	50~100	101~
	100%	95%	Per Quote

SESS

Code No.		P	@ / P (1~49P)					
Code	D		L60	L100	L150	L200	L250	L300
SESS	1	0.6 0.7 0.8	4.60	4.60	—	—	—	—
		0.6 0.7 0.8	—	3.30	3.50	—	—	—
	1.5	0.9	—	3.40	3.60	—	—	—
		1.0 1.2	—	3.30	3.50	—	—	—
	2	0.7	—	2.70	2.80	3.10	—	—
		0.8	—	2.70	2.80	3.00	—	—
		0.9	—	2.70	2.80	3.10	—	—
		1.0	—	2.70	2.80	3.00	—	—
		1.1	—	2.70	2.80	3.10	—	—
		1.2	—	2.70	2.80	3.00	—	—
		1.3 1.4	—	2.70	2.80	3.10	—	—
		1.5	—	2.70	2.80	3.00	—	—
		1.6 1.8	—	2.70	2.80	3.10	—	—
		0.8	—	—	2.80	3.10	—	—
	2.5	0.9	—	—	2.80	3.00	—	—
		1.0	—	—	2.80	3.00	—	—
		1.1	—	—	2.80	3.10	—	—
		1.2	—	—	2.80	3.00	—	—
		1.3 1.4	—	—	2.80	3.10	—	—
		1.5	—	—	2.80	3.00	—	—
		1.6 1.7 1.8 1.9	—	—	2.80	3.10	—	—
		2.0	—	—	2.80	3.00	—	—
		2.1	—	—	2.80	3.10	—	—
		1.0	—	—	3.00	3.40	4.80	6.40
	3	1.1	—	—	3.00	3.40	—	—
		1.2	—	—	3.00	3.30	4.70	6.40
		1.3 1.4	—	—	3.10	3.40	4.70	6.40
		1.5	—	—	3.00	3.30	4.70	6.40
		1.6 1.7	—	—	3.10	3.40	—	—
		1.8	—	—	3.00	3.30	—	—
		1.9	—	—	3.10	3.40	—	—
		2.0	—	—	3.00	3.30	—	—
		2.1 2.2 2.3 2.4 2.5 2.6	—	—	3.10	3.40	—	—
		4	2.0 2.5 3.0	—	—	4.50	4.70	6.10
	4.5	2.0 2.5	—	—	5.10	5.40	6.10	—
	5	3.0	—	—	5.70	6.20	8.10	—



440-C Straight Ejector Pins

S440-C Metric Ejector Pins

440-C Stainless Steel (56-60 Rc)

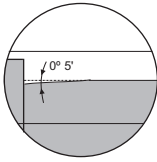

NOTE: Under Head—Manufacturing Taper 0° 5'

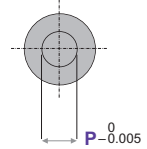
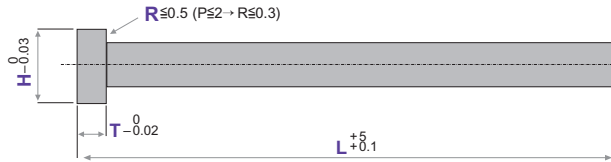

ORDER	Code No.	L
	S440C	100
	S440C J	150

Code No.		L		S440C		S440C J		
Code	P			T	H	T	H	
S440C	1	100	150					
	1.1	100	150					
	1.2	100	150					
	1.3	100	150		3			
	1.4	100	150					
	1.5	100	150					
	1.6	100	150					
	1.7	100	150					
	1.8	100	150			4		
	1.9	100	150					
	2	100	150					
	2.1	100	150					
	2.2	100	150					
	2.3	100	150		4	5		
	2.4	100	150					
	2.5	100	150					
	2.6	100	150					
	2.7	100	150					
2.8	100	150			6			
2.9	100	150						
3	100	150						
3.5	100	150						
4	100	150			7			
4.5	100	150					8	
5	100	150			8	6	9	
5.5	100	150						
6	100	150			9		10	

PRICE	1~49	50~100	101~
	100%	95%	Per Quote

Code No.		@ / P (1~49P)		
Code	P	L100	L150	L200
S440C	1	3.50	3.90	—
	1.1 1.2 1.3 1.4	3.30	3.70	5.00
	1.5	3.10	3.50	4.70
	1.6 1.7 1.8 1.9	3.10	3.50	4.30
	2	3.10	3.50	3.90
	2.1 2.2 2.3 2.4	3.50	3.90	4.20
	2.5	3.50	3.90	4.20
	2.6 2.7 2.8 2.9	3.50	4.00	4.40
	3	3.50	4.00	4.60
	3.5	3.60	4.20	4.70
4	3.90	4.60	4.90	
S440C	4.5 5	4.60	4.70	5.20
S440C J	5.5	4.70	5.00	5.60
	6	5.40	5.70	6.10